

FLANGED TYPE AXIAL CHECK VALVE CA 3242

Ref. : CA 3242.pas

Rev. : B

Date : 28/10/2015



PA Ventil AB

GO WITH OUR FLOW

APPLICATION

General use : water distribution.

GENERALES CHARACTERISTICS

From DN 50 to DN 600.
All positions thanks to the stainless steel spring.
Respect the flow direction indicated by an arrow on the body
With steel strainer basket and 6 mm mesh.
Weak head loss thanks to the cylindrical internal designing.
Anti-corrosion epoxy internal and external painting
blue color RAL 5017, 100 μ thickness
Bronze bushing to avoid blocking of the disc.
Drilled boss on request for bypass or to check the thickness.
Disc designed for a better hydrodynamism.
Silent solution.
Minimum back pressure for tightness : 0.2 bars.

CONSTRUCTION

14		Circlip	Stainless steel 302
13		Circlip	Stainless steel 302
12		Lifting plug	Acier
11		Pin DIN 913	Stainless steel 304
10		Pin DIN 916	Stainless steel 304
9		O ring	EPDM
8		Cap	Steel
7	1	Gasket	EPDM
6	1	Spring	Stainless steel 302
5	1	Bushing	Bronze
4	1	Guide	Ductile iron EN-GJS-400-15
3	1	Stem	Stainless steel 304 (DN50-300) Stainless steel 316 (DN350-600)
2	1	Disc	Ductile iron EN-GJS-400-15
1	1	Body	Cast iron EN-GJL-250 - (DN50-300) Ductile iron EN-GJS-400-15 - (DN350-600)
Pos.	Q-ty	Description	Matière

DIMENSIONS

DN		L	\varnothing De	\varnothing D	\varnothing K	n x \varnothing d	Weight (kg)
mm	inch						
50	2"	100	104	165	125	4 x 19	5.42
65	2 1/2"	120	127	185	145	4 x 19	8.22
80	3"	140	157	200	160	8 x 19	10.13
100	4"	165	180	220	180	8 x 19	13.53
125	5"	195	215	250	210	8 x 19	19.5
150	6"	230	250	285	240	8 x 23	27.07
200	8"	290	335	340	295	12 x 23	46.8
250	10"	355	410	405	355	12 x 28	77.2
300	12"	400	486	460	410	12 x 28	128
350	14"	480	550	505	460	16 x 23	260
400	16"	550	620	565	515	16 x 27	260
500	20"	680	780	670	620	20 x 26	500
600	24"	800	880	780	725	20 x 30	780

WORKING CONDITIONS

Maximum working pressure : 16 bar (DN50-300)
10 bar (DN350-600).
Maximum working temperature : -10°C / +130°C.

Test pressure according to EN 12266-1, DIN 3230, BS 6755 and ISO 5208 :

Body : 24 bar.
Seat : 17,6 bar.

STANDARDS

Flanges according to EN 1092-2 and DIN 2501/1 :
ISO PN10/16 up to DN150,
ISO PN16 from DN200 to DN300 and PN16 over.

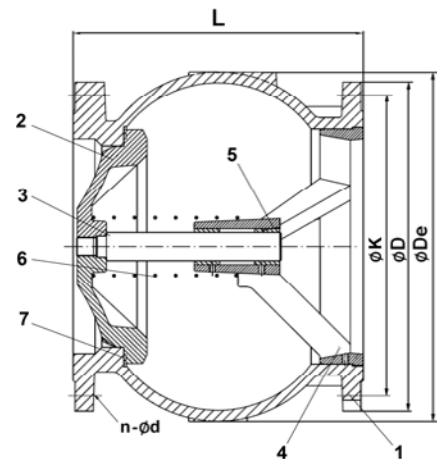

DN50-300

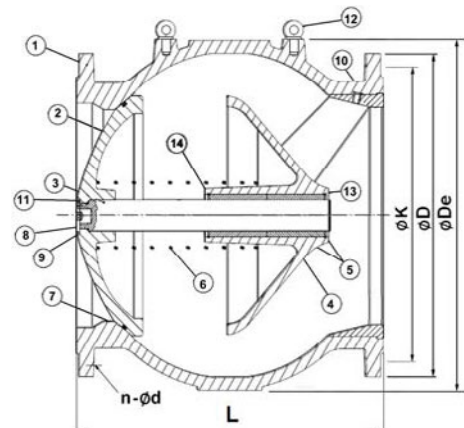

DN350-600

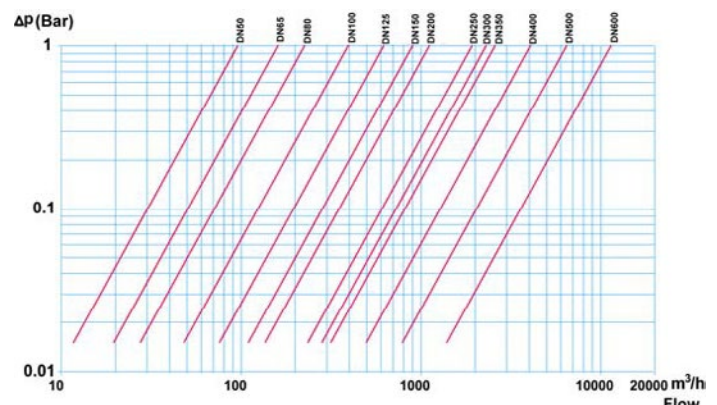

The photographs and technical art works are not contractual. The specifications of the presented products are open to modifications without previous advice.