

DOUBLE EXCENTRIC TYPE BUTTERFLY VALVE WITH ELECTRIC ACTUATOR AUMA

VP 4241-U04

Ref. : VP 4241-U04.pas

Rev. : E

Date : 03/11/2014



PA Ventil AB

GO WITH OUR FLOW

APPLICATION

General use : potable water.

GENERAL CHARACTERISTICS

TECWAT type : long pattern.
 Design in according to EN 593.
 Range : from DN 100 to DN 2000.
 Assembling with preferential sense
 Bi-directional on demand.
 Double excentric type.
 Replaceable seat, no wrenkling possibility.
 Food epoxy painting.

CONSTRUCTION

11	1	Electric actuator		AUMA
10	2	Key	Stainless steel X20Cr13	DIN: 1.4021 ASTM: AISI 420 BS: 420 S 37
9	2	O-ring	EPDM	
8	1	Sealing ring	EPDM	
7	1	Cover free end	Ductile iron EN-GJS-500-7	DIN: GGG 50 ASTM: A536 70-50-05 BS: 1563 EN-JS1050
6	2	Bearing bush	Al-Bronze	
5	1	Shaft free end	Stainless steel X20Cr13	DIN: 1.4021 ASTM: AISI 420 BS: 420 S 37
4	1	Shaft driven end	Stainless steel X20Cr13	DIN: 1.4021 ASTM: AISI 420 BS: 420 S 37
3	1	Retaining ring	Steel	
2	1	Disc	Ductile iron EN-GJS-500-7	DIN: GGG 50 ASTM: A536 70-50-05 BS: 1563 EN-JS1050
1	1	Body	Ductile iron EN-GJS-500-7	DIN: GGG 50 ASTM: A536 70-50-05 BS: 1563 EN-JS1050
Rep.	Nb.	Designation	Material	

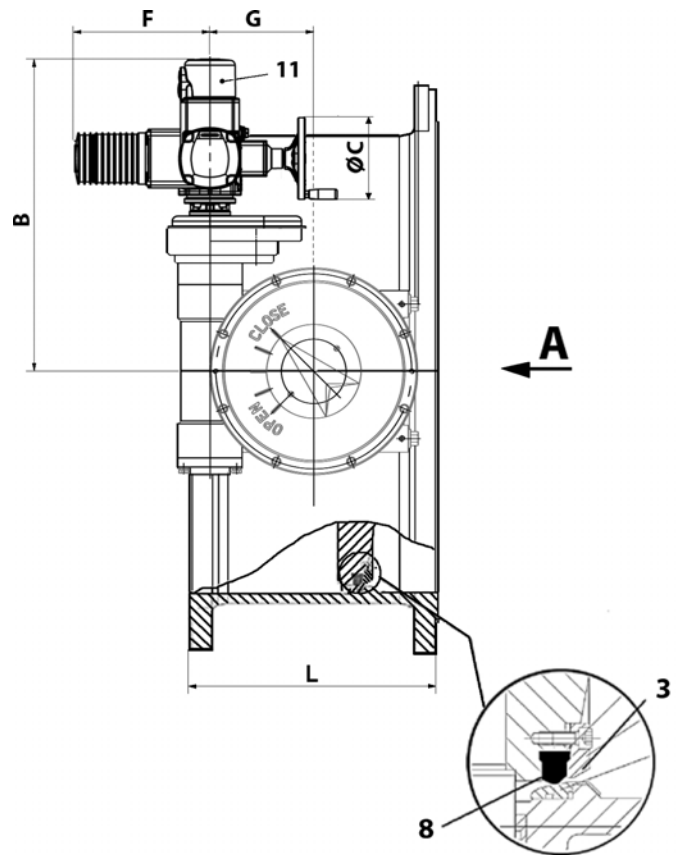

VIEW A

DIMENSIONS

DN	L	A	B	ØC	D	ØK	E	n-d	Actuator type	Weight (kg)
mm	inch									
100	4"	190	117	388	160	133	180	8-ø19	SA07.2	50
150	6"	210	147.5	388	160	164	240	8-ø23	SA07.2	55
200	8"	230	175	410	160	198	295	12-ø28	SA07.6	74
250	10"	250	207.5	453	200	230	355	12-ø28	SA07.6	109
300	12"	270	235	453	200	254	410	12-ø28	SA10.2	133
350	14"	290	265	465	200	295	470	16-ø28	SA10.2	191
400	16"	310	295	465	200	334	525	16-ø31	SA10.2	231
450	18"	330	325	591,5	200	368	585	20-ø31	SA07.6	326
500	20"	350	362,5	588,5	200	400	650	20-ø34	SA10.2	390
600	24"	390	425	588,5	200	480	770	24-ø37	SA10.2	553
700	28"	430	460	619,5	200	563	840	24-ø37	SA10.2	787
800	32"	470	517,5	619,5	315	623	950	24-ø41	SA14.2	998
900	36"	510	567,5	663	200	698	1050	28-ø41	SA10.2	1309
1000	40"	550	635,5	722,5	200	766	1170	28-ø44	SA10.2	1725
1200	48"	630	747,5	775	200	910,5	1390	32-ø50	SA10.2	2805
1400	56"	710	847,5	875	200	1063	1590	36-ø50	SA10.2	4125
1600	64"	790	970	935	315	1172	1820	36-ø52	SA10.2	5288
2000	80"	950	1177,5	1092	400	1583	2230	48-ø62	SA14.2	10057

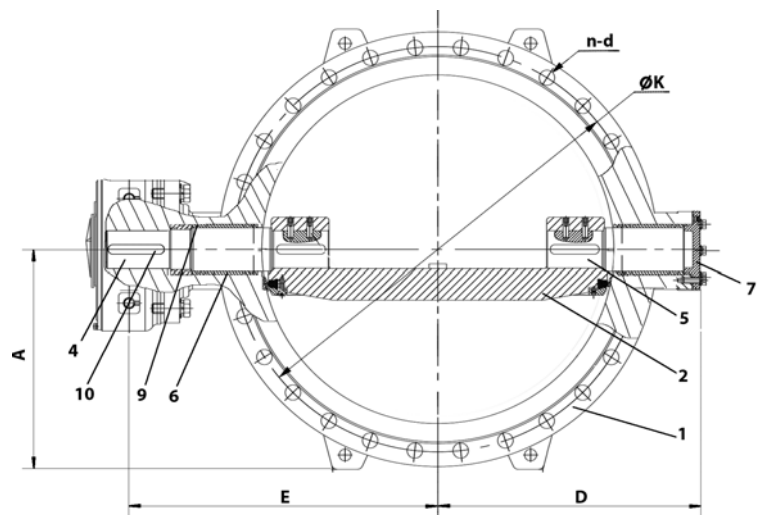

WORKING CONDITIONS

Maximum working pressure : 16 bar.
 Maximum temperature : + 80 °C.

STANDARDS

Design according to EN 593.
 Test procedures are established according to standards EN 12266-1 and API 598.
 Face to face according to standard EN 558-1 serie 14.
 Connections according to standard EN 1092-2
 ISO PN16.
 Optional certificat of health conformity (ACS) by request



The photographs and technical art works are not contractual. The specifications of the presented products are open to modifications without previous advice.